

Modern Style

1960-Present



The 1960s were a period of great change, with conventions being challenged and redefined, particularly through a growing youth culture. In Australia, the birth of our multicultural society was also beginning, with many European immigrants bringing new cultures, ideas, food and fashions.

By the 1960s the typical Australian home was a single-storey house built of brick, brick-veneer, weatherboard or fibro-cement.

Elsewhere in the Australian building industry were growth, expansion and development. Sky-scrapers grew taller and urban sprawl continued to change our cities.

Architects were using new materials and technologies in new ways - from the solid, stark style of 'brutalism' through to the 'structural' style of sporting and entertainment centres.

While these new building styles were also used for homes, many people started looking back to older styles as inspiration for their houses.

HOW TO ORDER YOUR MOULDING

Ordering your moulding is simple. We just need the answers to a few questions:

1. Are you painting or staining your moulding?
This will determine which timber you choose. If you are painting, choose Pine or MDF.
2. Choose the appropriate timber species
3. Choose your moulding number
4. Work out the quantity required.

If you wish to match an existing moulding, we require:

1. A sample or "to scale" drawing
2. Timber species required
3. Quantity required

Please call our friendly staff on 03 9808 5522 to help you with these questions.

**Hazelwood
& Hill**
1931-2011
80years

Phone 03 9808 5522
www.hazelwoodhill.com.au

18 McIntyre Street, Burwood Victoria 3125
sales@hazelwoodhill.com.au • Fax (03) 9808 7226

1198

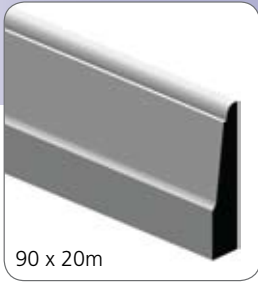

2120

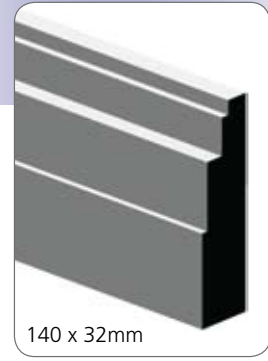

1137

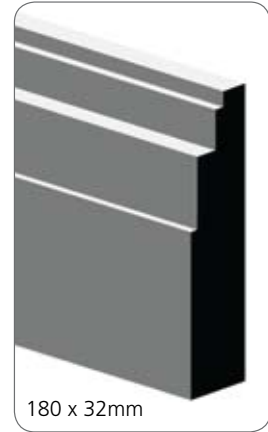
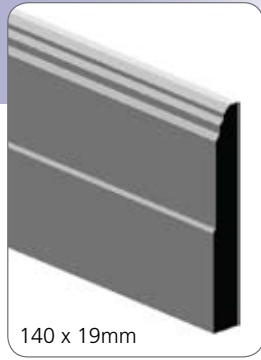
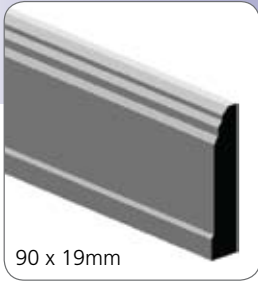

1113

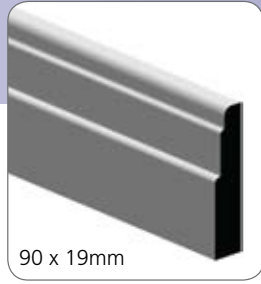
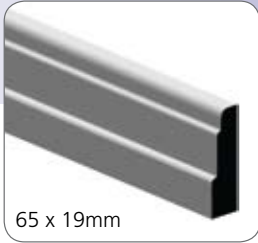

1109

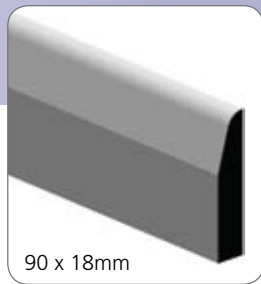

Many mouldings can be created to your own size specifications - please ask us about availability.

1147

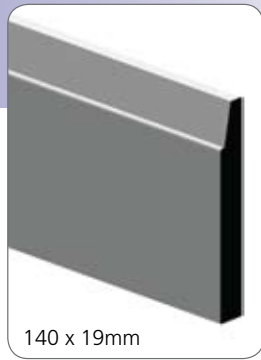
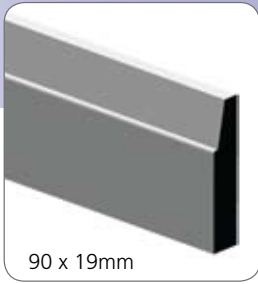

Mouldings are created from any species that are commercially available such as American Oak, Jarrah, Tasmanian Oak, Radiata Pine, Victorian Ash, Hoop Pine, Western Red Cedar and MDF. Mouldings can be painted or stained to suit your decor.

1185



2139



2140



1191



2151



2105



65 x 19mm



90 x 19mm

2111



65 x 19mm

1105

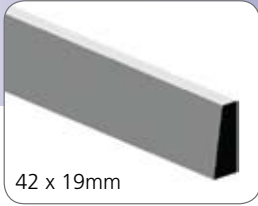

42 x 19mm



65 x 19mm



90 x 19mm

Stock Mouldings

We manufacture to order, although we do keep some of the most popular profiles in stock. These are labelled "Stock".

Stock:
Stepped



ST6519 - TAS OAK
ST6718 - PRIMED MDF
ST6518 - UNPRIMED
FINGER JOINTED PINE

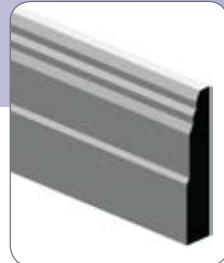

ST9019 - TAS OAK
ST9218 - PRIMED MDF
ST9018 - UNPRIMED
FINGER JOINTED PINE

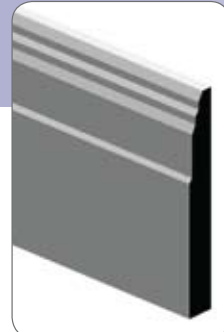

ST13519 - TAS OAK
ST14018 - PRIMED MDF
ST13518 - UNPRIMED
FINGER JOINTED PINE

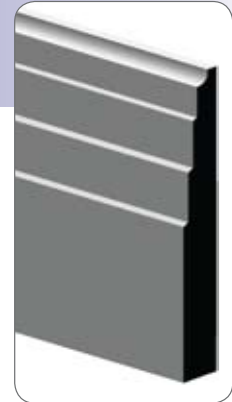

ST18018 - UNPRIMED
FINGER JOINTED PINE

Stock:
Half
Splayed

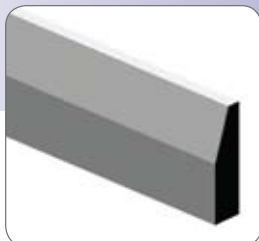

HS6718 - PRIMED MDF

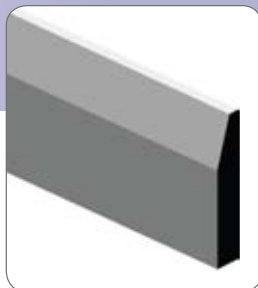

HS9218 - PRIMED MDF



HS14018 - PRIMED MDF

**Stock:
Lambs
Tongue**



LT6718 - PRIMED MDF
LT6618 - PRIMED
FINGER JOINTED PINE



LT9218 - PRIMED MDF
LT9218 - PRIMED
FINGER JOINTED PINE



LT14018 - PRIMED MDF
LT13818 - PRIMED
FINGER JOINTED PINE

**Stock:
Single
Bevel**

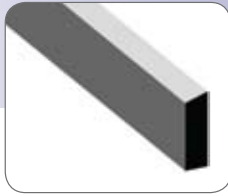

BE4212 - PRIMED
FINGER JOINTED PINE

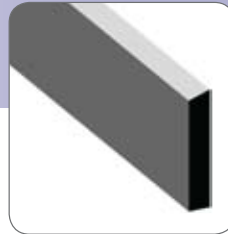

BE6612 - PRIMED
FINGER JOINTED PINE

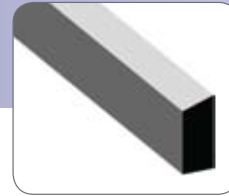

BE4219 - TAS OAK
BE4218 - PRIMED MDF
BE4218 - PRIMED
FINGER JOINTED PINE

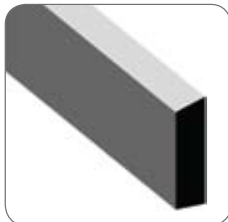

BE6519 - TAS OAK
BE6718 - PRIMED MDF
BE6618 - PRIMED
FINGER JOINTED PINE

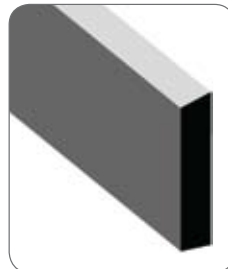

BE9019 - TAS OAK
BE9218 - PRIMED MDF
BE9218 - PRIMED
FINGER JOINTED PINE

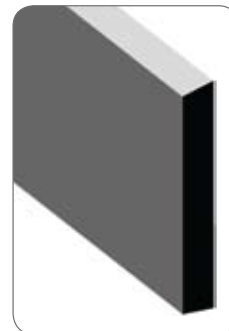

BE14018 - PRIMED MDF
BE13818 - PRIMED
FINGER JOINTED PINE

**Stock:
Bullnose**



BN6519 - TAS OAK
BN6718 - PRIMED MDF
BN6618 - PRIMED
FINGER JOINTED PINE



BN9019 - TAS OAK
BN9218 - PRIMED MDF
BN9218 - PRIMED
FINGER JOINTED PINE



BN14018 - PRIMED MDF
BN13818 - PRIMED
FINGER JOINTED PINE



BN18518 - PRIMED
FINGER JOINTED PINE

Stock Mouldings

We manufacture to order, although we do keep some of the most popular profiles in stock. These are labelled "Stock".